

INTO MANCHESTER



Discover your perfect university

Pathway programmes for international students

2022-23

NCUK
THE UNIVERSITY CONSORTIUM



“The most important thing I learned from studying in the UK was continuous self-development. The British Education system is the best in the world and employees perceive my qualification as a great achievement.”

Samal, Kazakhstan
BSc (Hons) Management, The University of Manchester
MSc Accounting and Finance, London School of Economics and Political Science



Discover the right university

Welcome to INTO Manchester, where university success starts with the best preparation.

For almost any subject you wish to study, we can offer you a guaranteed route to up to 25+ universities in the UK. From Business and Law, to Science and Engineering – there are so many options. If you're not sure what subject is right for you, don't worry. You're not the first student we've helped to make this decision – thousands of students have progressed to their chosen university with our help.

When you choose INTO Manchester, you'll be choosing one of the UK's most popular study destinations. This vibrant city has one of the largest student communities in the UK*, so you'll feel at home right from the start. You'll experience a truly international education, studying alongside students from as many as 70 nationalities. And with our Study Centre located in the heart of the city, student life couldn't be easier!

Choose #INTOManchester and open up a lifetime of opportunities.

* Higher Education Statistics Agency 2019



“I really enjoyed my studies at INTO Manchester. I think it's a wonderful place to be and it's a great family of teachers and classmates. The teachers, placement officers and course managers at INTO Manchester are always ready to help.”

Jac, Singapore
BSc (Hons) Physiotherapy,
Manchester Metropolitan
University



“Studying with INTO meant that when I progressed to university, I was really prepared and knew what to expect. It was great to have a year to adapt to living in a new country, to get used to the culture and living alone without your parents for the first time.”

Ilya, Kazakhstan
BEng (Hons) Petroleum Engineering, The University of Manchester

**3rd best city
in the UK
for students**

(QS Best Student Cities 2019)

**TOP 10
most exciting
cities in the world**

(Time Out City Life Index 2018)

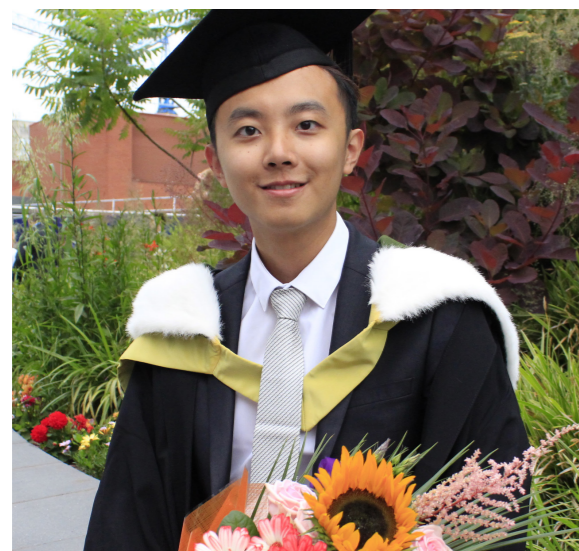

“The accounting classes I had at INTO Manchester worked as a stepping stone for the second year of university. The modules were useful as they taught me how to write good lecture notes, prepare for seminars and cope with presentations, which are really important for university study in the UK.”

Chit Yat, Hong Kong
Assurance Associate at Ernst & Young
BSc (Hons) Accounting and Financial Management,
University of Sheffield



Guaranteed progression

Choosing to study abroad is a big decision, but with INTO Manchester you can relax knowing we are here to support you on your journey towards university.

Choose your university

Thanks to our partnership with NCUK, if you successfully complete your pathway programme you will have guaranteed progression to one of these 25+ universities*. With many of the universities specialising in different subject areas, and with locations varying from bustling city centre to beautiful campuses, there will be an NCUK university to suit you.

You also have the freedom and flexibility to apply to other UK universities if you prefer. Can't decide? We're here to help. Whenever you have any questions about university applications or need advice about study options, our Student Placement Team are here to support you.



Placement services

Our dedicated Student Placement Team at INTO Manchester will provide you with friendly and practical counselling, assisting you with every stage of the university application process including:

- advising you on your study options
- helping with your university application
- helping with your personal statement
- arranging for you to visit universities.

"With over 20 years' experience of the UCAS system we are the main support for students through every step of the process. We'll help you select the university that's right for you, create outstanding personal statements or give you the details of your progression course. We have regular drop-in sessions but you can also just visit our office and ask questions."

Steven Faulder,
Student Placement Team, INTO Manchester

* Progression options from International Year One are possible to 13 universities. For more details see page 16.



"The Placement Officers at INTO helped me a lot with my personal statement – and I think the University loved it, so that was good! After exams, I didn't need much help. It was a really straightforward process."

Samir, Mexico
Progressed to BEng (Hons) Aerospace Engineering,
The University of Manchester



"A lot of people come to university in the UK for the first time and struggle to handle it – but I feel like having five months at INTO getting used to everything was extremely helpful."

Sonya, Malaysia
Progressed to LLB (Hons) Law,
The University of Manchester

We have already helped thousands of students prepare for university

Are you ready to join this list of top students?

 <p>The University of Manchester</p> <p>Yulia, Ukraine Physics with Astrophysics</p>	 <p>Manchester Metropolitan University</p> <p>Juyuong, South Korea Hospitality Business Management</p>	 <p>University of Salford</p> <p>Karin, Singapore Physiotherapy</p>	 <p>University of Birmingham</p> <p>Yik Huen, Hong Kong Geography and Urban and Regional Planning</p>
 <p>University of Bristol</p> <p>Yuan, China Aerospace Engineering</p>	 <p>Leeds Beckett University</p> <p>Anousha, Pakistan Business Management</p>	 <p>University of Kent</p> <p>Samantha, Costa Rica Law</p>	 <p>Kingston University</p> <p>Sulaiman, Kuwait Pharmacy</p>

Life at the INTO Centre

Are you ready to live and learn in one of the UK's biggest* and best** student cities? With modern facilities in a historic building, an exciting programme of activities and a team of friendly staff, INTO Manchester has it all!

Your Study Centre

The INTO Manchester Centre offers you the chance to study in one of the most exciting and diverse cities in the world. Located in Bridgewater House, an impressive Edwardian building, the Centre is right in the heart of bustling Manchester. Most of your classes will take place here and you'll find everything you need to study and socialise in one location.

Our academic programmes here are taught in a similar way to what you'll experience at university so that you'll be ready when you progress. INTO Manchester's modern learning Centre includes:

- 49 classrooms featuring digital whiteboards
- well-equipped computing suites
- free Wi-Fi and internet access throughout
- 24/7 access to our virtual learning environment to download resources
- a Learning Resource Centre, with a wide range of online journals, books and excellent study materials
- silent study areas.

If you want a break between classes, relax in the break-out spaces where you can play table football with friends, or head out to the many cafés and shops on your doorstep. You'll soon feel right at home!

Supporting you

Studying in another country can be a big adjustment, and we're here to help you. Our friendly **Student Services team** will help you with accommodation and visa support, and the orientation programme in your first week will cover everything from opening a bank account to getting around the city.

Our experienced teaching staff will help you to understand the UK higher education system. We operate an open-door policy for most academic staff rooms and hold optional revision classes for each subject during exam periods. You'll also be allocated a Personal Tutor upon arrival.

Your safety is our priority

There's a 24-hour emergency telephone helpline if you need to speak to someone out of office hours. If you're under 18, we offer extra support which includes ensuring your safe transfer from the airport and checking on you each day at the residence where you'll live. You'll also receive a dedicated named person to contact to ensure your wellbeing and receive a copy of our code of conduct, which you must follow; especially outside of class when you'll be unsupervised. For more information, please see guidance for under 18s using the link below:

www.intostudy.com/into-manchester/terms

INTO Manchester has been established for **13 years**



"My advice is quite simple. Balance your academic life and social life – it is the key. You will usually find that you have the highest efficiency when you have both rather than just one of them."

Thi Minh, Vietnam
BEng (Hons) Electrical and Electronic Engineering, The University of Manchester



Get involved and make friends

We'll make it easy for you to meet new people and find new, fun things to do. Our staff will organise regular social activities and help you enjoy Manchester to the fullest. By taking part in our social programme, you'll have the chance to meet other students and explore sights in Manchester and the rest of the UK.

We also organise regular sporting activities and student events to help you make great friends and memories, including:

- Chinese New Year
- Christmas
- Easter
- Eid
- Halloween

Distance from INTO Centre to...

train stations:
10 minute walk to Manchester Piccadilly
3 minute walk to Manchester Oxford Road

accommodation:
5 – 15 minute walk

city centre:
5 minute walk to nearby supermarkets, restaurants, banks and coffee shops

Chinatown:
8 minute walk

Manchester Airport:
up to 20 minute journey by train

95%
student satisfaction for support

(INTO Annual Student Experience Survey 2021)

"We look forward to welcoming you to the dynamic city of Manchester. We have a team of experienced staff to help you with both academic matters and day-to-day living so you can concentrate on your studies and make the most of your time with us."

Dawn Abbott, Centre Director



* Invest in Manchester 2021 ** QS Best Student Cities 2019

Discover Manchester

A varied mix of music, shopping, sport and a buzzing social scene all wrapped up in one student-focused city. Get ready to explore one of the most exciting cities in the world, bursting with cultural events and authentic international cuisine.

One of the world's most exciting cities

(Time Out Index 2019)

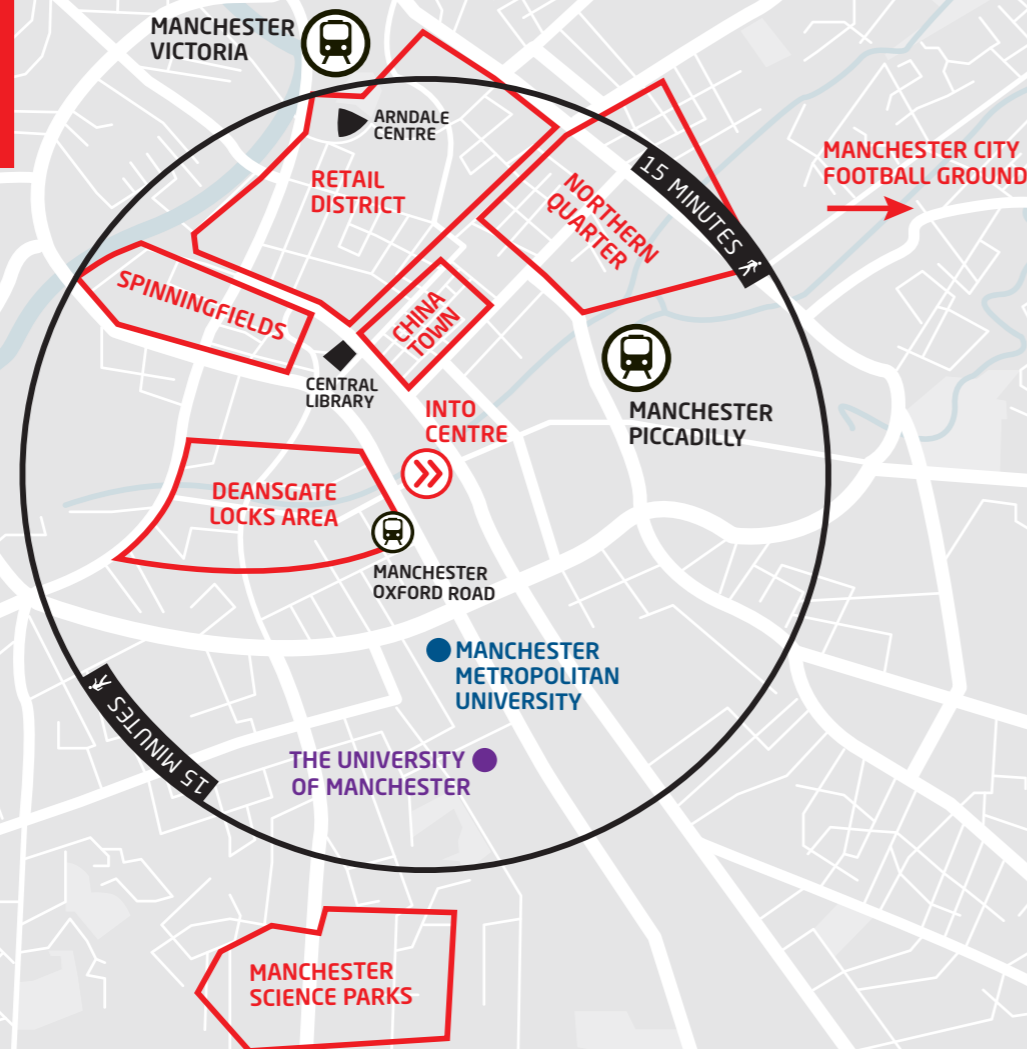

"I have spent most of my adult life in Manchester. It's like a love story: I fell in love, and now I have settled. After two or three months studying in Manchester, I thought I could stay here for a long time."

Nicholas, Malaysia

Entrepreneur
LLB (Hons) Law,
The University of Manchester

Culture and creativity

When you live in Manchester, you'll be immersed in a diverse world of music, art and fashion. You'll also have access to a bustling social calendar packed with festivals, events, and free activities.

The city has a number of museums and art galleries, including:

- The Whitworth Art Gallery
- Manchester Museum
- Manchester Art Gallery
- Centre for Chinese Contemporary Art
- National Football Museum
- Science and Industry Museum

The Portico, Chetham and Manchester Central Libraries are also a must-see in a city designated a **UNESCO City of Literature***

* Manchester City of Literature for the UNESCO
** Statista 2020

Gourmet to everyday

With hundreds of restaurants in the city, there is an exciting range of quality, modern British and international cuisine available, making it easy to find foods from around the world.

From fine dining in **Spinningfields** to street food at the seasonal The Maker's Market, you'll find options to suit your mood and budget.

Deansgate offers everything from tapas to traditional British food while the cool cafés of the **Northern Quarter** are a favourite with locals.

Manchester's **Chinatown** is the second largest in Britain and has many Asian restaurants and supermarkets. There are also many restaurants and shops in **Rusholme**, offering South Asian and Middle Eastern cuisine and produce. You'll never run out of exciting options in Manchester!

An iconic sporting city

Manchester is home to two of the biggest names in sport: Manchester United and Manchester City. Manchester United's ground, **Old Trafford**, is the biggest stadium in the English Premier League**, while Manchester City are based at the striking **Etihad Stadium**.

Fancy getting involved? The city offers a range of state-of-the-art facilities from indoor ski-slopes to velodromes. Sport is at the heart of Manchester.

Getting out and about

Manchester is easy to get around on foot, by bus or by tram, and it's a great base to explore the UK - you can get to London in just two hours by train and to the Lake District in just under two hours. **Manchester Airport** also has flights to 199+ destinations!

SHOP 'TIL YOU DROP

From the high street to chic boutiques, Manchester is the place for fashion

- Arndale Centre** - high street styles
- Northern Quarter** - vinyl and vintage boutiques
- Trafford Centre** - 200+ shops under one roof
- The Avenue** - designer labels
- Afflecks** - hipster's paradise



Your home from home

INTO Manchester's safe student accommodation options enable you to live as part of a vibrant student community, or you can immerse yourself in British family life with a homestay experience. You decide!

En suite student residences

Just a short walk from the INTO Centre, your accommodation has a central location which means you'll be close to many restaurants, cafés and shops.

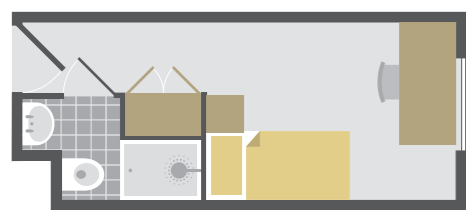

- En suite bathroom
- Communal areas
- Laundry facilities
- Accepts under 18s
- 24/7 staff
- Wi-Fi

Example room layout

For full details of our accommodation options, visit: www.intostudy.com/manchester/accommodation

INTO Manchester aims to provide the accommodation requested. However, there may be occasions when INTO Manchester is unable to provide the requested accommodation and reserves the right to offer an alternative type of accommodation instead. The price for any alternative accommodation may differ and will be confirmed to students at the time of their offer.

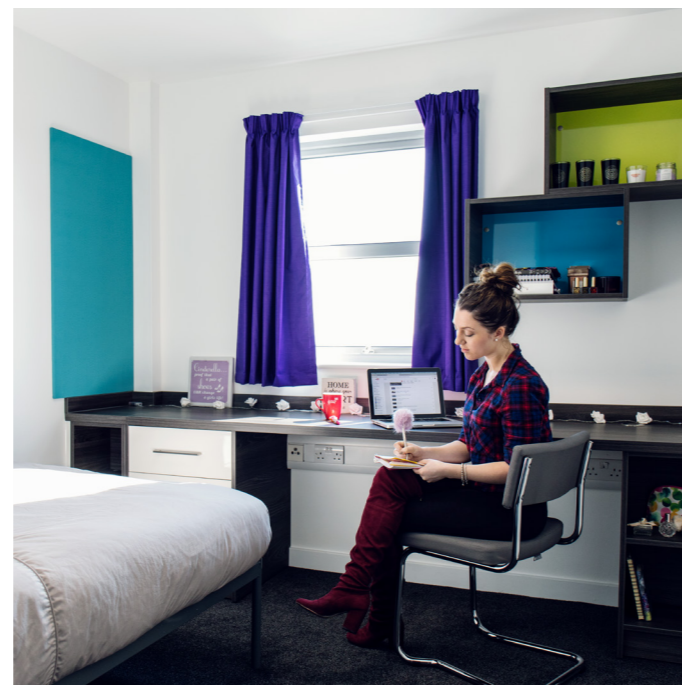

Supporting you

In all the residences, you'll find staff available 24/7 to offer support, and we'll also provide you with a 24-hour emergency helpline telephone number. If you're under 18 and living in INTO managed accommodation, we offer extra support from residential tutors; as well as checking in on you each day at the student residence where you live.

Homestay

This is a unique opportunity to experience British life and culture first hand. You'll have a private room in a carefully selected host's home, sharing mealtimes and living spaces.



Example communal space

Choosing your course

Prepare for your university degree with our tailored, academic pathway programmes. You'll benefit from university-style teaching for subject-based modules and high academic standards. Then, when it comes to progressing to your chosen degree, we'll support you with your university application.

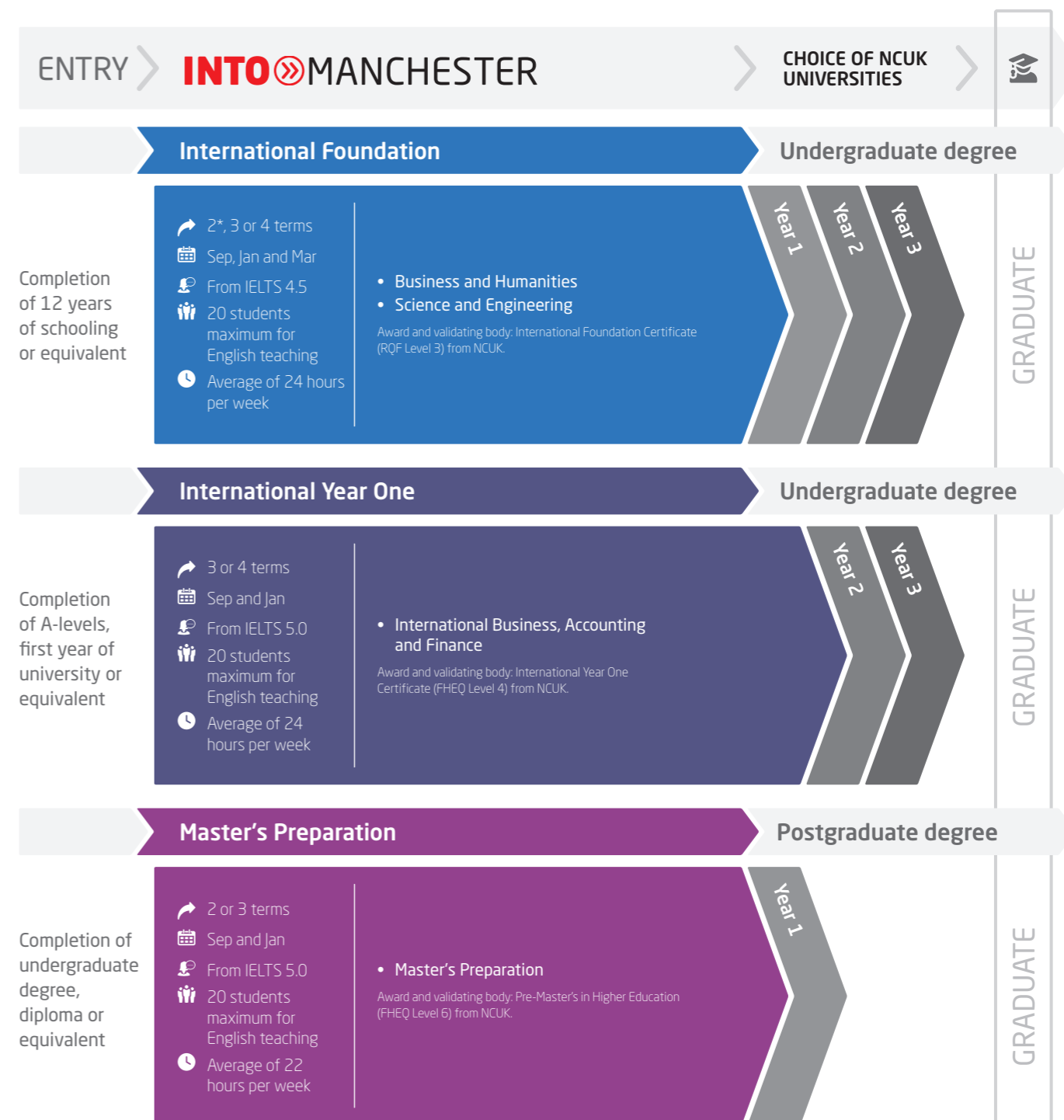

* 2 term option is for Business and Humanities pathway only

Please note that course length and start month options may vary depending on the pathway chosen. Please visit www.intostudy.com/into-manchester/courses for full information.

We also offer **English courses**. Go to page 19 for more information.

Progress to Year 1 of an undergraduate degree at an NCUK university

Start date

- 2 term: Mar
- 3 term: Sep or Jan
- 4 term: Jun or Sep

English language entry requirements*

- 2 term: UKVI IELTS 6.0 (with a minimum of 6.0 in writing) or equivalent
- 3 term: UKVI IELTS 5.0 (with a minimum of 5.0 in writing) or equivalent
- 4 term: UKVI IELTS 4.5 (with a minimum of 4.5 in writing) or equivalent

Age requirement

16 years and above**

* If you do not meet the minimum English language requirements you should apply for our Academic English course. See page 19 for more information.
 ** All students commencing courses on a published September start date must be 17 years old by 31 December of that calendar year. For all other start dates, students must be 17 years old on the published start date of the programme.

INTO Manchester students can progress to:

University of Leeds



12th in the UK for Economics
 (The Complete University Guide 2022)

The University of Manchester



32nd in the world for Business and Management Studies
 (QS World University Rankings by Subject 2021)

International Foundation

Business and Humanities



Progress to **1 of 25+** universities. Scan the QR code to find out more.

- › Improve your presentation, report writing and exam skills.
- › Learn to construct academic opinions and arguments with confidence in preparation for university study.

What will I study?

English for Academic Purposes and Study Skills
 Information Communication Technologies (ICT)*

3 out of 4:**

- Business Studies
- Economics
- Mathematics
- Global Studies

Special features

- › Explore business-related theories and their practical application using real-world case studies.
- › Practise professional presentation skills through assessed group work.
- › Improve your reporting skills following independent research projects.
- › Improve your exam-taking techniques through regular assessments.
- › Prepare for classes by reviewing articles and videos uploaded to our online learning environment in advance of classes.

* Compulsory but non-credit bearing.
 ** The choice of modules depends on your intended degree programme. Some combinations may not be offered. Modules offered are subject to change



“For international students, Manchester is the perfect place to study! The Centre is in the city centre and there are lots of student societies and associations.”

Manami, Japan
 BA (Hons) Events Management,
 University of Huddersfield

“I thought what made the experience great were the teachers. They were extremely helpful. I went to them with questions beyond the scope of my studies.”

Kai, Singapore
 MEng (Hons) Engineering, University of Cambridge

International Foundation

Science and Engineering



Progress to **1 of 25+** universities. Scan the QR code to find out more.

- › Gain valuable experience and build familiarity with laboratory work through practical-based learning.
- › Improve your scientific research, reasoning and writing through varied learning techniques practised on the programme.

What will I study?

English for Academic Purposes and Study Skills
 Information Communication Technologies (ICT)*

3 out of 5:**

- Biology
- Chemistry
- Further Mathematics
- Mathematics
- Physics

Special features

- › Practise academic writing skills, particularly relating to laboratory reports.
- › Visit different faculties to meet with academic staff and gain an insight into different degree programmes.
- › Progress to a degree offering a placement year option.
- › Attend NCUK university fair held in the Centre.

* Compulsory but non-credit bearing.
 ** The choice of modules depends on your intended degree programme. Some combinations may not be offered.

“Studying in the UK has shaped me into a much more confident person. I improved my skills in teamwork, decision making and communication.”

Moosa, India
 BEng (Hons) Petroleum Engineering,
 The University of Manchester



“I would definitely recommend INTO Manchester because of the amazing support they have. In terms of academia, applications or wellbeing you know there’s always someone there for you.”

Springsfield, Singapore
 LLB (Hons) Law, University of Birmingham

Progress to Year 1 of an undergraduate degree at an NCUK university

Start date

- 3 term: Sep or Jan
- 4 term: Jun or Sep

English language entry requirements*

- 3 term: IELTS 5.0 (with a minimum of 5.0 in writing) or equivalent
- 4 term: IELTS 4.5 (with a minimum of 4.5 in writing) or equivalent

Age requirement

16 years and above**

* If you do not meet the minimum English language requirements you should apply for our Academic English course. See page 19 for more information.
 ** All students commencing courses on a published September start date must be 17 years old by 31 December of that calendar year. For all other start dates, students must be 17 years old on the published start date of the programme.

INTO Manchester students can progress to:

University of Bradford



Top 20 in the UK for Pharmacy and Pharmacology
 (The Complete University Guide 2022)

The University of Bristol



Top 150 in the world for Engineering and Technology
 (QS World University Rankings by Subject 2021)

Find your course

International Foundation progression

You can progress to more than 4,000 degrees at 25+ universities from this programme.

The following table provides an indication of what grades you need to achieve to be guaranteed a place at university. For the most up-to-date information visit www.intostudy.com/into-manchester/courses

Grade equivalents table

Grade	%	Academic modules	
		NCUK points	EAP module
A*	>80%	56 points	7.5
A	70-79%	48 points	7
B	60-69%	40 points	6.5
C	50-59%	32 points	6
D	40-49%	24 points	5.5
E	35-39%	16 points	5
U	<35%	-	-

University	Accounting and Finance › Accounting › Economics › Finance › Investment › Mathematics	Architecture › Architecture › Construction Management › Quantity Surveying	Art and Design › Animation › Fine Art › Graphic Design › Illustration › Photography › Textiles* › Fashion Design* › Fashion Marketing /Management	Business and Management › Business Studies › Construction Management › Management › Marketing	Computing › Business Information Systems › Computer Games Design › Computing › Information Systems	Engineering › Aeronautical › Aerospace › Automotive › Chemical › Civil › Electrical › Mechanical › Medical › Petroleum › Renewable › Software	Hospitality and Tourism › Events Management › Hospitality Management › Tourism Management	Humanities › Archaeology › Development Studies › Education › Geography › History › Liberal Arts › Modern Languages › Music*	Law › Criminology › Law	Media › Advertising › Digital Media › Film Production › Journalism › Media Studies	Psychology › Psychology	Science › Biological and Biomedical Sciences › Chemistry › Pharmacology › Pharmacy and Pharmaceutical Science › Physics › Zoology	Social Science › Criminology › International Relations › Politics › Sociology	Sport and Exercise › Exercise and Sport Sciences
Aston University	Grades: BBB EAP: B	N/A	N/A	Grades: ABB-BBC EAP: B-C	Grades: BBB EAP: B	Grades: BBB EAP: B	N/A	Grades: BBB EAP: C	Grades: BBB EAP: B	N/A	Grades: BBB EAP: B	Grades: ABB-BBB EAP: B-C	Grades: BBB EAP: C	N/A
University of Birmingham	Grades: AAA-AAB EAP: B-C	N/A	N/A	Grades: AAB EAP: B	Grades: A*AA-AAA EAP: C	Grades: AAA-AAB EAP: C	N/A	Grades: AAB EAP: B	Grades: AAA EAP: A	N/A	N/A	Grades: A*AA-ABB EAP: A-C	Grades: ABB-BBB EAP: B	N/A
University of Bradford	Points: 112 EAP: C	N/A	N/A	Points: 112 EAP: C	Points: 112 EAP: C	Points: 112 EAP: C	N/A	N/A	Points: 112 EAP: C	N/A	Points: 112 EAP: C	Points: 120-112 EAP: B-C	Points: 11-296 EAP: C	Points: 136 EAP: B
University of Bristol	Grades: A*A*A-AAA EAP: A-B	N/A	N/A	N/A	Grades: A*A*A-AAA EAP: B	Grades: A*AA-AAA EAP: B	N/A	Grades: AAB EAP: A	Grades: A*AA EAP: A	Grades: AAB EAP: A	Grades: A*AA-ABB EAP: A-B	Grades: A*AA-ABB EAP: B	Grades: AAA-ABB EAP: A	N/A
Brunel University	Grades: BBB - ABB EAP: C - B	N/A	N/A	Grades: BBC - BBB EAP: C - B	Grades: ABB - BBB EAP: C - B	Grades: ABB - BBB EAP: C - B	N/A	Grades: CCC - BBB EAP: B	Grades: ABB EAP: B	Grades: BBB - BBC EAP: B	Grades: BBB EAP: B	Grades: BBB - BBC EAP: C - B	Grades: BBB - BBC EAP: C - B	Grades: BBC EAP: B
Cardiff University	Grades: AAA - ABB EAP: B	Grades: AAA - AAB EAP: B	N/A	Grades: AAB - ABB EAP: B	Grades: AAB - BBB EAP: B	Grades: AAA - BBB EAP: B	N/A	Grades: ABB - BCC EAP: B	Grades: AAB - ABB EAP: B	Grades: ABB - BBB EAP: B	Grades: AAA - AAB EAP: B	Grades: AAA - BBB EAP: B	Grades: ABB - BBB EAP: B	N/A
University of Central Lancashire	Grades: BBB - BCC EAP: C	Grades: AAB - ABB EAP: C	Grades: BBC - BCC EAP: C	Grades: BBC - BCC EAP: C	Grades: BBC - BCC EAP: C	Grades: BBB - BCC EAP: C	N/A	Grades: BBC - BCC EAP: C	Grades: BBC - BCC EAP: C	Grades: BBC - BCC EAP: C	Grades: BBB - BBC EAP: C	Grades: BBC - BCC EAP: C	Grades: BBC - BCC EAP: C	N/A
Durham University	Grades: A*A*A* - AAB EAP: not listed	N/A	Grades: AAB EAP: not listed	Grades: AAA - AAB EAP: not listed	Grades: A*AA EAP: not listed	Grades: A*AA EAP: not listed	N/A	Grades: AAB - ABB EAP: not listed	Grades: A*AA - AAB EAP: not listed	N/A	Grades: AAA - AAB EAP: not listed	Grades: A*AA - AAB EAP: not listed	Grades: A*AA - ABB EAP: not listed	N/A
University of Exeter	Grades: A*AA - AAA EAP: B	N/A	Grades: AAB - ABB EAP: B	Grades: AAA - ABB EAP: B	Grades: AAA - ABB EAP: B	Grades: AAA - ABB EAP: B	N/A	Grades: AAA - ABB EAP: B	Grades: AAA - ABB EAP: B	Grades: AAB - ABB EAP: B	Grades: A*AA - AAB EAP: B	Grades: A*AA - ABB EAP: B	Grades: AAB - ABB EAP: B	Grades: A*AA - ABB EAP: B
Harper Adams University	N/A	N/A	N/A	Grades: BBC - BCC EAP: C	N/A	Grades: AAB - BBB EAP: C	N/A	N/A	N/A	N/A	N/A	Grades: BBC EAP: C	N/A	N/A
University of Huddersfield	Grades: BBB EAP: C	Grades: BBB EAP: C	Grades: BBB EAP: C	Grades: BBB EAP: C	Grades: BBB EAP: C	Grades: AAB-BBC EAP: C	N/A	N/A	Grades: BBB-BBC EAP: C	N/A	Grades: BBB EAP: C	Grades: AAB-BBB EAP: A-C	Grades: BBC EAP: C	N/A
Keele University	Grades: ABC - BBC EAP: C	N/A	N/A	Grades: BBC EAP: C	Grades: BBC EAP: C	N/A	N/A	Grades: BBC EAP: C	Grades: BBB - BBC EAP: C	Grades: BBC EAP: C	Grades: BBB EAP: C	Grades: ABB - BBC EAP: A - C	Grades: BBC EAP: C	Grades: BBC EAP: C
University of Kent	Grades: ABB EAP: B	N/A	Grades: BBB EAP: B	Grades: ABB-BBB EAP: B	Grades: AAB-ABB EAP: B	Grades: ABB-BBB EAP: B	N/A	Grades: ABB EAP: B	Grades: ABB-BBC EAP: B	Grades: BBB EAP: B	Grades: AAB EAP: B	Grades: ABB-BBB EAP: B	Grades: ABB-BBB EAP: B	Grades: BBB EAP: B
Kingston University	Points: 120-112 EAP: B-C	Points: 128-96 EAP: C	Points: 104 EAP: C	Points: 112-104 EAP: B-C	Points: 112 EAP: C	Points: 128-112 EAP: C	N/A	Points: 112-96 EAP: C	Points: 120 EAP: C	Points: 112 EAP: C	N/A	Points: 128-80 EAP: B-C	Points: 112 EAP: B	N/A
Lancaster University	Grades: AAA - ABB EAP: C	Grades: AAB EAP: C	Grades: ABB EAP: C	Grades: AAB - ABB EAP: C	Grades: AAA - AAB EAP: C	Grades: AAA - ABB EAP: C	N/A	Grades: AAA - AAB EAP: C	Grades: AAB - ABB EAP: C	Grades: AAB - ABB EAP: C	Grades: AAA - AAB EAP: C	Grades: AAA - ABB EAP: C	Grades: AAB - ABB EAP: C	Grades: ABB EAP: C
University of Leeds	Grades: AAA-AAB EAP: B-C	Grades: AAA EAP: C	Grades: AAA-ABB EAP: C	Grades: AAB-ABB EAP: B	Grades: AAA EAP: C	Grades: AAA EAP: C	N/A	Grades: AAA-ABB EAP: B	Grades: AAB EAP: B	N/A	Grades: AAA EAP: A	Grades: AAB EAP: C	Grades: AAB-ABB EAP: B	Grades: AAA-ABB EAP: C
Leeds Beckett University	Points: 112 EAP: C	Points: 120-94 EAP: C	Points: 112-96 EAP: C	Points: 112-96 EAP: C	Points: 96 EAP: C	Points: 96 EAP: C	Points: 72 EAP: C	Points: 128 EAP: C	Points: 112-104 EAP: C	Points: 128-96 EAP: C	Points: 112 EAP: C	Points: 128-112 EAP: C	Points: 104 EAP: C	Points: 120-72 EAP: C
Liverpool Hope University	Grades: BBC EAP: C	N/A	Grades: BBC EAP: C	Grades: BBC EAP: C	Grades: BBC EAP: C	N/A	Grades: BBC EAP: C	Grades: BBB - BBC EAP: C	Grades: BBC EAP: C	Grades: BBC EAP: C	N/A	Grades: BBC EAP: C	Grades: BBC EAP: C	N/A
Liverpool John Moores University	Points: 112 EAP: C	Points: 120-112 EAP: C	N/A	Points: 112 EAP: C	Points: 112 EAP: C	Points: 112 EAP: C	N/A	Points: 112 EAP: C	Points: 112 EAP: C	Points: 112 EAP: B	Points: 128-104 EAP: C	Points: 112-104 EAP: C	Points: 104 EAP: C	Points: 280-104 EAP: C
The University of Manchester	Grades: A*AA-ABB EAP: A-C	Grades: AAA EAP: B	Grades: AAB-ABB EAP: B-C	Grades: AAA EAP: A	Grades: A*A*A EAP: B	Grades: AAA EAP: B	N/A	Grades: AAA-ABB EAP: B	Grades: AAA-ABB EAP: A	N/A	Grades: AAB EAP: B	Grades: A*AA-ABB EAP: A-B	Grades: AAA-ABB EAP: B	N/A
Manchester Metropolitan University	Points: 96-88 EAP: C	N/A	Points: 96 EAP: C	Points: 96 EAP: C	Points: 96 EAP: C	Points: 112-96 EAP: C	Points: 96 EAP: C	Points: 96 EAP: C	Points: 96 EAP: C	Points: 96 EAP: C	Points: 112 EAP: C	Points: 112-96 EAP: A-C	Points: 96 EAP: C	Points: 96 EAP: C
Queen Mary, University of London	Grades: AAA-AAB EAP: A-C	N/A	N/A	Grades: ABB EAP: A	Grades: AAB-ABB EAP: C	Grades: AAB-ABB EAP: C	N/A	N/A	N/A	Grades: AAB-ABB EAP: A-C	N/A	Grades: AAB-ABB EAP: B	Grades: AAA EAP: A	N/A
Robert Gordon University	N/A	N/A	Grades: BBC EAP: B	Grades: BBC EAP: B - C	N/A	N/A	Grades: BBC EAP: B	N/A	N/A	N/A	N/A	N/A	N/A	N/A
University of Salford	Points: 112 EAP: C	Points: 112-104 EAP: C	Points: 112-96 EAP: C	Points: 112-104 EAP: C	Points: 120-104 EAP: C	Points: 108 EAP: C	Points: BCC EAP: C	Points: 112-96 EAP: C	Points: 112-104 EAP: C	Points: 112 EAP: C	Points: 112 EAP: C	Points: 120-96 EAP: C	Points: 112-96 EAP: C	Points: 120-104 EAP: C
The University of Sheffield	Grades: AAA-ABB EAP: B	Grades: AAA EAP: B	N/A	Grades: AAB-ABB EAP: B	Grades: AAA-AAB EAP: B	Grades: AAA-ABB EAP: B-C	N/A	Grades: ABB EAP: A-B	Grades: AAA-AAB EAP: A	Grades: ABB EAP: A*	Grades: AAB EAP: B	Grades: AAA-AAB EAP: A-C	Grades: BBB EAP: B	N/A
Sheffield Hallam University	Points: 112 EAP: C	Points: 128 EAP: C	N/A	Points: 120-112 EAP: C	Points: 128-96 EAP: C	Points: 128-112 EAP: C	Points: 96 EAP: C	N/A	Points: 120-112 EAP: B	Points: 112 EAP: B	Points: 120 EAP: B	Points: 112-104 EAP: C	Points: 112-104 EAP: B	N/A

Placement year options available at all universities. Universities reserve the rights to change the entry requirements. For the latest information contact the Centre. For some programmes at NCUK universities, you may need specific grades from specified subjects in the Foundation which may impact on your eligibility. Applicants to many Architecture, Art and Design courses may require a portfolio in addition to the Foundation certificate.

* For progression to these subject areas, you may need to demonstrate evidence of previous experience in these specialisms.

Progress to Year 2 of an undergraduate degree at an NCUK university

Start date

3 term: Jan or Sep
4 term: Jun or Sep

English language entry requirements*

3 term: UKVI IELTS 5.5 (with a minimum of 5.5 in reading and writing) or equivalent
4 term: UKVI IELTS 5.0 (with a minimum of 5.0 in all subskills) or equivalent

Age requirement

17 years and above**

* If you do not meet the minimum English language requirements you should apply for our Academic English course. See page 19 for more information.

** All students commencing courses on a published September start date must be 18 years old by 31 December of that calendar year. For all other start dates, students must be 18 years old on the published start date of the programme.

INTO Manchester students can progress to:

University of Leeds

Top 150

in the world for Accounting and Finance

(QS World University Rankings by Subject 2021)

International Year One

International Business, Accounting and Finance



Progress to **1 of 13** universities**. Scan the QR code to find out more.

- > Choose your specialist pathway post-arrival after a common first semester.
- > Up to 13 universities to choose from.
- > Complete your degree in the same time as a home student.

What will I study?

You will need to earn 120 credits from the following module options to successfully complete your pathway programme:

Semester 1:

Business Economics (15 credits)	Financial Accounting 1 (15 credits)
Business Skills (15 credits)	Organisational Behaviour (15 credits)
English for Academic Purposes and Study Skills (EAP)*	

At the end of your first semester you will continue to one of the following two pathways based on your chosen progression option:

Semester 2

English for Academic Purposes and Study Skills (EAP)*	Business and Management pathway (BM)
	Quantitative Methods for Business (15 credits)
Accounting and Finance pathway (AF)**	Management Accounting (15 credits)
Business Finance (15 credits)	Management Themes and Case Studies (15 credits)
Quantitative Methods for Business (15 credits)	Marketing (15 credits)
Financial Accounting 2 (15 credits)	
Management Accounting (15 credits)	

* Compulsory but non credit bearing.

** If you select modules for the Accounting and Finance pathway you will not be able to progress to The University of Manchester.

You can progress to one of more than 50+ degrees from this programme. This table highlights some of the most popular degrees available:

University	Degree	Pathway	UCAS code	EAP grade	Credits	Average score %
University of Bradford	Accounting and Finance BSc (Hons)	AF/BM	N420	C	120	60+
University of Bradford	Business and Management BSc (Hons)	AF/BM	N100	C	120	60+
University of Huddersfield	International Business BA (Hons)	AF/BM	N124	C	105+	50+
University of Huddersfield	Supply Chain Management BA (Hons)	AF/BM	J960	C	105+	50+
Keele University	Accounting and Finance	AF/BM	NN34	C	108	60
Keele University	Economics	AF/BM	LNC3	C	120	55
Keele University	International Business Management	BM	N120	C	120	55
University of Leeds	Accounting and Finance BSc (Hons)	AF	N420	B	120	70+
University of Leeds	International Business BSc (Hons)	AF/BM	NN13	B	120	60+
University of Leeds	Business Management with Marketing BA (Hons)	BM	N2N5	B	120	60+
Leeds Beckett University	Business Management with Finance BA (Hons)	AF/BM	N1N3	C	105+	40+
Leeds Beckett University	Events Management BA (Hons)	BM	N820	C	105+	50+
Liverpool John Moores University	Accounting and Finance BSc (Hons)	AF/BM	N420	C	120	50+
Liverpool John Moores University	Business and Public Relations BA (Hons)	BM	NP12	C	120	50+
Manchester Metropolitan University	Accounting and Finance BA (Hons)	AF	NN34	C	105+	50+
Manchester Metropolitan University	Business Management BA (Hons)	AF/BM	N201	C	105+	50+
Manchester Metropolitan University	Events Management BA (Hons)	BM	N821	C	105+	50+
University of Salford	Accounting and Finance BSc (Hons)	AF/BM	NN34	C	120	50+
University of Salford	Business and Economics BSc (Hons)	AF/BM	N1L1	C	120	50+
University of Salford	Human Resource Management BSc (Hons)	AF/BM	N1N6	C	120	50+
The University of Sheffield	Accounting and Financial Management BSc (Hons)	AF	N420	B	120	65+
The University of Sheffield	Business Management BA (Hons)	BM	N200	B	120	65+
Sheffield Hallam University	Accounting and Finance BA (Hons)	AF	N4N3	C	105+	50+
Sheffield Hallam University	Business Management BA (Hons)	AF	N201	C	105+	50+
Sheffield Hallam University	Business and Marketing BA (Hons)	BM	NN15	C	105+	50+

Degree option with a year in industry also available.

Find comprehensive information on all academic pathway programmes, degree options and progression requirements at: www.intostudy.com/into-manchester/courses

Master's Preparation



Progress to **1 of 25+** universities. Scan the QR code to find out more.

- > Develop your academic and postgraduate research skills in your chosen field.
- > An ideal preparation course for students who want to study a Master's degree at a UK university.

What will I study?

English for Academic Purposes
Management Studies*
Research Methods

* Compulsory but non credit bearing.

Special features

- > A guaranteed place at one of the NCUK universities, dependent on academic history, work experience and successful completion of the programme.
- > Learn to prepare literature reviews, research proposals and correct referencing techniques.
- > Experience authentic assessments that mirror those at university.
- > Receive assistance with all stages of the application process, through individual tutorials with an INTO Manchester tutor.
- > Become involved in the organisation of, and present your research at, a conference.
- > Benefit from small group tuition, taught by award-winning NCUK teachers in a supportive environment.

Being academically pre-qualified for progression to your choice of university is essential. This programme cannot be used as an academic top-up.



"Studying the Master's Preparation course at INTO Manchester was really beneficial for me in lots of ways. As a result, I was one step ahead of my classmates when I started my Master's and I think I owe my success to that."

Ayhanim, Turkey
MSc Marketing, University of Salford

"The first week at INTO Manchester is filled with activities, and you will have the opportunity to discover the city. You won't be lost because the staff are so helpful and important information will be given to you."

Cramaix, Cameroon
MA (Hons) Logistics and Supply Chain Management, Manchester Metropolitan University

Progress to a postgraduate degree at an NCUK university

Start date

2 term: Jan
3 term: Sep

English language entry requirements*

2 term: UKVI IELTS 5.5 (with a minimum of 5.5 in reading and writing) or equivalent
3 term: UKVI IELTS 5.0 (with a minimum of 5.0 in reading and writing) or equivalent

Please note: for visa purposes, students requiring a Tier 4 visa must have UKVI IELTS 5.5 (with a minimum of 5.5 in all subskills) or equivalent.

Age requirement

21 years and above

* If you do not meet the minimum English language requirements you should apply for our Academic English course. See page 19 for more information.

INTO Manchester students can progress to:

University of Birmingham

Top 20

in the UK

(The Complete University Guide 2022)

The University of Manchester

Top 30

in the world

(QS World University Rankings 2022)

University of Bristol

Top 100

in the world

(QS World University Rankings 2022)

The University of Sheffield

Top 100

in the world

(QS World University Rankings 2022)

Master's Preparation progression

The progression grades from the Master's Preparation are outlined in the table below. These progression grades are the requirements from your programme at INTO Manchester and are in addition to any other academic or employment requirements outlined for your desired programme at your chosen university.

University	Accounting and Finance › Accounting › Actuarial Science › Banking › Economics › Finance	Business and Management › Business Studies › International Business › Management › MBA	Marketing › Digital Marketing › International Marketing › Strategic Marketing › Marketing	Sports and Leisure Management, and Logistics › Entrepreneurship › Human Resource Management › Logistics › Risk Management › Sport Business Management › Supply Chain Management
Aston University	EAP: Grade B overall; Research Module: Pass	EAP: Grade B overall; Research Module: Pass	EAP: Grade B overall; Research Module: Pass	EAP: Grade B overall; Research Module: Pass
University of Birmingham	EAP: Grade B overall; Research Module: Pass	EAP: Grade A or B overall; Research Module: Pass	EAP: Grade A overall; Research Module: Pass	EAP: Grade A overall; Research Module: Pass
University of Bradford	EAP: Grade B or C overall; Research Module: Pass	EAP: Grade B overall; Research Module: Pass	EAP: Grade B overall; Research Module: Pass	EAP: Grade B overall; Research Module: Pass
University of Bristol	EAP: Grade A or B overall; Research Module: Distinction	EAP: Grade A overall; Research Module: Distinction	EAP: Grade A overall; Research Module: Distinction	EAP: Grade B overall; Research Module: Distinction
Brunel University	EAP: B Research Module: Pass	EAP: B Research Module: Pass	EAP: B Research Module: Pass	EAP: C - B Research Module: Pass
University of Exeter	"EAP: B Research Module: Pass"	"EAP: A - B Research Module: Pass"	"EAP: B Research Module: Pass"	"EAP: B Research Module: Pass"
University of Huddersfield	EAP: Grade C overall; Research Module: Pass	EAP: Grade C overall; Research Module: Pass	EAP: Grade C overall; Research Module: Pass	EAP: Grade C overall; Research Module: Pass
Keele University	EAP: C Research Module: Pass	EAP: B Research Module: Pass	EAP: B Research Module: Pass	EAP: B Research Module: Pass
University of Kent	EAP: Grade B overall; Research Module: Pass	EAP: Grade B overall; Research Module: Pass	EAP: Grade B overall; Research Module: Pass	EAP: Grade B overall; Research Module: Pass
Kingston University London	EAP: Grade B overall; Research Module: Pass	EAP: Grade B overall; Research Module: Pass	EAP: Grade B overall; Research Module: Credit	EAP: Grade B overall; Research Module: Pass
University of Leeds	EAP: Grade B overall; Research Module: Pass	EAP: Grade B overall; Research Module: Pass	EAP: Grade B overall; Research Module: Pass	EAP: Grade B overall; Research Module: Pass
Leeds Beckett University	EAP: Grade C overall; Research Module: Pass	EAP: Grade C overall; Research Module: Pass	EAP: Grade C overall; Research Module: Pass	EAP: Grade B or C overall; Research Module: Pass
Liverpool Hope University	N/A	EAP: B Research Module: Pass	EAP: B Research Module: Pass	EAP: B Research Module: Pass
Liverpool John Moores University	EAP: Grade C overall; Research Module: Pass	EAP: Grade B or C overall; Research Module: Pass	EAP: Grade C overall; Research Module: Pass	EAP: Grade B or C overall; Research Module: Pass
The University of Manchester	EAP: Grade A or B overall; Research Module: Pass	EAP: Grade A or B overall; Research Module: Pass	EAP: Grade A overall; Research Module: Pass	EAP: Grade A or B overall; Research Module: Pass
Manchester Metropolitan University	EAP: Grade B overall; Research Module: Pass	EAP: Grade B overall; Research Module: Pass	EAP: Grade B overall; Research Module: Pass	EAP: Grade B overall; Research Module: Pass
Queen Mary, University of London	EAP: Grade A or B overall; Research Module: Pass	EAP: Grade A or B overall; Research Module: Pass	EAP: Grade A overall; Research Module: Pass	EAP: Grade A overall; Research Module: Pass
Robert Gordon University	EAP: B Research Module: Pass	EAP: B Research Module: Pass	EAP: B Research Module: Pass	EAP: B Research Module: Pass
University of Salford Manchester	EAP: Grade B overall; Research Module: Pass	EAP: Grade B overall; Research Module: Pass	EAP: Grade B overall; Research Module: Pass	EAP: Grade B overall; Research Module: Pass
The University of Sheffield	EAP: Grade B or C overall; Research Module: Pass	EAP: Grade B overall; Research Module: Pass	EAP: Grade B overall; Research Module: Pass	EAP: Grade B overall; Research Module: Pass
Sheffield Hallam University	EAP: Grade C overall; Research Module: Pass	EAP: Grade B or C overall; Research Module: Pass	EAP: Grade C overall; Research Module: Pass	EAP: Grade B or C overall; Research Module: Pass

Find comprehensive information on all academic pathway programmes, degree options and progression requirements at: www.intostudy.com/into-manchester/courses

English courses

Study English at INTO Manchester to improve your English level fast with tailored, personalised support and for the smoothest transition to further UK academic studies.

EN Academic English

This course is for you if:

- › You want to study an English course that is more than language learning – you'll develop the academic skills needed to successfully study in the UK.
- › You want to benefit from studying in an English-speaking environment where you can easily practice your language skills and immerse yourself in the culture.

How will Academic English benefit me?

- Focus on reading, writing, speaking and listening in a context that reflects the skills you must have in order to succeed at university.
- Gain the academic language skills you need to succeed in further UK education.
- Prepare to pass any English language assessments you may need to take, such as IELTS.
- You'll have regular one-to-one tutorials with your teachers where you'll receive detailed feedback and help with your individual study plan.
- Take advantage of a diverse social programme, effective academic content and unique language learning opportunities in the city, which will help you to develop the fluency and confidence you need to progress to further study.
- You'll be taught by highly experienced English teachers who have worked in many different countries and have a wide range of expertise, including course development, materials writing and assessment management.
- Extended International Foundation courses available with a term of Academic English in one programme.



"I enjoy teaching on the Academic English programme because I feel I can make a real difference to our students in developing the language and study skills they need when they get to university, in a relatively short amount of time. Seeing how much progress they can make in just ten intensive weeks is really rewarding."

Kes Poupaert
Academic English teacher, INTO Manchester

"Studying Academic English was quite different to studying IELTS. For me, the most important skill I gained was how to write in a more academic style. Our teachers placed a lot of emphasis on this skill as it's essential for successful university study. Studying Academic English helped me adapt to the style of teaching and learning at UK universities. Now I feel I will achieve better grades."

Suxuan, China
Academic English, INTO Manchester

Improve your English language skills to prepare for further academic study

Start date

16 weeks: Aug
1-4 terms: Sep, Jan, Apr, Jun

English language entry requirements

From IELTS 3.0 or equivalent

Age requirement

16 years and above

Class size and hours

Maximum of 16 students

30 learning hours per week, with 25 hours of face-to-face contact

Note: 1 term = 11 weeks (10 of which are teaching weeks)

Accredited by the



for the teaching of English in the UK

All our English language courses at INTO Manchester have received accreditation from the British Council.

Dates and prices

The cost of your programme may vary depending on factors including the pathway chosen and programme length. The following guide to costs is based on pricing for the current academic year and provides an indication of the cost of attendance for some of our pathways. For specific cost information, please refer online: www.intostudy.com/into-manchester/courses

Estimated cost of attendance based on prices for current academic year 2021–2022

Study length	Tuition	Accommodation	Books and fees	Airport pick up**	Insurance	Total
Academic programmes						
International Foundation (2 term)	£15,650	£4,000-£7,500	£435	£45	£196	£20,281-£23,781
International Foundation (3 term)	£16,475	£6,400-£12,000	£435-£835	£45	£357	£23,667-£29,667
International Foundation (4 term)	£18,495	£8,160-£15,300	£530-£930	£45	£466	£27,651-£35,191
International Year One (3 term)	£16,475	£6,400-£12,000	£435	£45	£357	£23,667-£29,267
Master's Preparation (3 term)	£15,650	£6,240-£11,700	£435	£45	£357	£22,682-£28,142
English language courses						
1 term*	£4,430	£1,760-£3,300	£95	£45	£122	£6,407-£7,947
16 weeks	£7,090	£2,560-£4,800	£135	£45	£145	£9,930-£12,170

Start months and term dates

Academic programmes		Academic English	
September (3 term)	Mon 12 Sep 2022-Fri 16 Jun 2023	August (16 weeks)	Mon 08 Aug 2022-Fri 09 Dec 2022
September (3 term Master's Preparation)	Mon 26 Sep 2021-Fri 23 Jun 2022	September (1 term)	Mon 26 Sep 2022-Fri 09 Dec 2022
September (4 term)	Mon 26 Sep 2022-Fri 25 Aug 2023	January (1 term)	Mon 09 Jan 2023-Fri 24 Mar 2023
January (3 term)	Mon 09 Jan 2023-Fri 25 Aug 2023	April (1 term)	Tue 03 Apr 2023-Fri 16 Jun 2023
March (2 term)	Mon 06 Mar 2023-Fri 25 Aug 2023	June (1 term)	Mon 26 Jun 2023-Fri 08 Sep 2023

Please note the dates and prices shown are for the current academic year of 01 September 2021 – 31 August 2022 and are for indicative purposes only. All students who confirm their offer on or before 31 January 2022 will pay the 2021/2022 price as per their existing offer letter. After 31 January 2022, where tuition fees have increased or dates changed, students will receive a new offer letter detailing the new 2022/2023 pricing and dates. For full details of term dates, please visit the relevant course page at www.intostudy.com/into-manchester/courses

* The price will depend on your start date and length of study. Prices shown are only for one term.
Vacation weeks in between terms are extra and will be charged at the weekly accommodation price.

** Please note airport pickup is optional and is not included in the total.



Apply via your local INTO educational counsellor

If you would like us to put you in contact with one of our counsellors, please contact us.



Apply online

Complete our online application form: apply.intostudy.com



Need some help with your tuition fees?

Check to see if you're eligible for a scholarship: www.intostudy.com/into-manchester/scholarships

Discover more online

For students:

www.intostudy.com/into-manchester

For education counsellors:

partnerportal.intoglobal.com/into-manchester

Connect with us



Contact us

Enquiries and applications:

ukes@intoglobal.com

or +44 1273 876040

Visit the Centre:

manchester.marketing@intoglobal.com

or +44 161 631 1200

Centre address details:

INTO Manchester
Bridgewater House
58/60 Whitworth Street
Manchester
M1 6LT
United Kingdom



Through innovative partnerships with leading universities, we expand opportunities for higher education, ensuring success and transforming the lives of our students and staff.

INTO GIVING

Working across the globe, INTO Giving supports projects that increase access to education and improve the quality of teaching and learning. For more information visit www.into-giving.com

Education counsellor's stamp

